

Anaphylaxis Individual Emergency Care Plan – Wall Township Public Schools

Name: _____ D.O.B.: _____

Allergy to: _____

Weight: _____ lbs. Asthma: Yes (higher risk for a severe reaction) No

Does student have a documented incident of anaphylaxis? Yes No

Extremely reactive to the following: _____

Therefore:

- Give epinephrine immediately for **ANY** symptoms if there was a likely exposure.
- Give epinephrine immediately if there was exposure to the allergen, **even if no symptoms are noted.**

Otherwise:

Any SEVERE SYMPTOMS after suspected or known exposure:

One or more of the following:

- LUNG: Short of breath, wheeze, repetitive cough
- HEART: Pale, blue, faint, weak pulse, dizzy, confuse
- THROAT: Tight, hoarse, trouble breathing/swallowing
- MOUTH: Obstructive swelling (tongue and/or lips)
- SKIN: Many hives over body

Or **combination** of symptoms from different body areas:

- SKIN: Hives, itchy rashes, swelling (e.g., eyes, lips)
- GUT: Vomiting, crampy pain

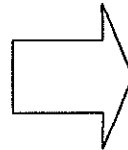

1. INJECT EPINEPHRINE IMMEDIATELY

2. Call 911
3. Begin monitoring (see box on back page)
4. Give additional medications.*
(If ordered)
-Antihistamine
-Inhaler (bronchodilator) if asthma

*Antihistamine & inhalers/bronchodilators are not to be depended upon to treat a severe reaction (anaphylaxis). USE EPINEPHRINE.

MILD SYMPTOMS ONLY:

- MOUTH: Itchy mouth
- SKIN: A few hives around mouth/face, mild itch
- GUT: Mild nausea/discomfort

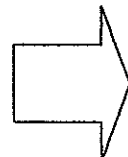

1. GIVE ANTIHISTAMINE

2. Stay with student; alert healthcare professional and parent
3. Dismiss student to care of parent or guardian
4. If symptoms progress (see above), USE EPINEPHRINE

Medication/Doses:

Epinephrine: 0.15mg or 0.3mg May repeat dose in 15 minutes if symptoms continue.

Antihistamine: _____

Other (e.g., inhaler-bronchodilator if asthmatic): _____

*Please note that by NJ state law only the administration of epinephrine can be delegated to non-nursing school staff.

Self-Administration:

I have instructed the above student in the proper administration of epinephrine. It is my opinion that he/she is capable of self-administration. Student must notify teacher or School Nurse when he/she has administered epinephrine.

OR

It is my opinion that the above student **is not** capable of self-administration.

Contacts: Doctor: _____ Phone: _____

Parent/Guardian: _____ Phone: _____

Other Emergency Contact: _____ Phone: _____

Doctor's Office Stamp

Parent/Guardian Signature Date

Healthcare Provider Signature Date

HOW TO USE AUVI-Q® (EPINEPHRINE INJECTION, USP), KALEO

1. Remove Auvi-Q from the outer case.
2. Pull off red safety guard.
3. Place black end of Auvi-Q against the middle of the outer thigh.
4. Press firmly until you hear a click and hiss sound, and hold in place for 2 seconds.
5. Call 911 and get emergency medical help right away.

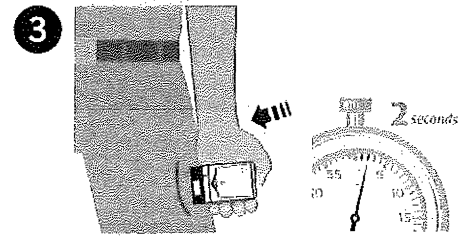

HOW TO USE EPIPEN® AND EPIPEN JR® (EPINEPHRINE) AUTO-INJECTOR, MYLAN

1. Remove the EpiPen® or EpiPen Jr® Auto-Injector from the clear carrier tube.
2. Grasp the auto-injector in your fist with the orange tip (needle end) pointing downward.
3. With your other hand, remove the blue safety release by pulling straight up.
4. Swing and push the auto-injector firmly into the middle of the outer thigh until it 'clicks'.
5. Hold firmly in place for 3 seconds (count slowly 1, 2, 3).
6. Remove and massage the injection area for 10 seconds.
7. Call 911 and get emergency medical help right away.

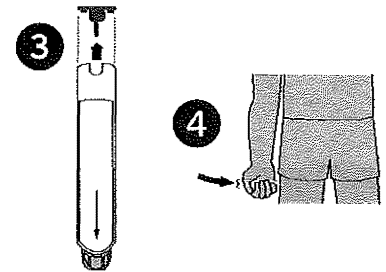

HOW TO USE EPINEPHRINE INJECTION (AUTHORIZED GENERIC OF EPIPEN®), USP AUTO-INJECTOR, MYLAN

1. Remove the epinephrine auto-injector from the clear carrier tube.
2. Grasp the auto-injector in your fist with the orange tip (needle end) pointing downward.
3. With your other hand, remove the blue safety release by pulling straight up.
4. Swing and push the auto-injector firmly into the middle of the outer thigh until it 'clicks'.
5. Hold firmly in place for 3 seconds (count slowly 1, 2, 3).
6. Remove and massage the injection area for 10 seconds.
7. Call 911 and get emergency medical help right away.

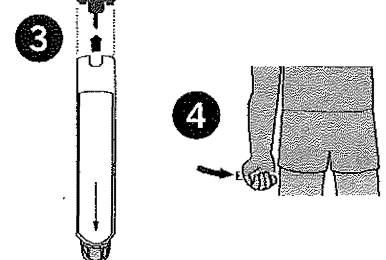

HOW TO USE IMPAX EPINEPHRINE INJECTION (AUTHORIZED GENERIC OF ADRENALCLICK®), USP AUTO-INJECTOR, IMPAX LABORATORIES

1. Remove epinephrine auto-injector from its protective carrying case.
2. Pull off both blue end caps: you will now see a red tip.
3. Grasp the auto-injector in your fist with the red tip pointing downward.
4. Put the red tip against the middle of the outer thigh at a 90-degree angle, perpendicular to the thigh.
5. Press down hard and hold firmly against the thigh for approximately 10 seconds.
6. Remove and massage the area for 10 seconds.
7. Call 911 and get emergency medical help right away.

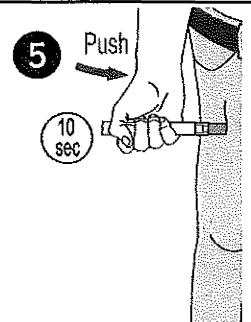

ADMINISTRATION AND SAFETY INFORMATION FOR ALL AUTO-INJECTORS:

1. Do not put your thumb, fingers or hand over the tip of the auto-injector or inject into any body part other than mid-outer thigh. In case of accidental injection, go immediately to the nearest emergency room.
2. If administering to a young child, hold their leg firmly in place before and during injection to prevent injuries.
3. Epinephrine can be injected through clothing if needed.
4. Call 911 immediately after injection.

OTHER DIRECTIONS/INFORMATION (may self-carry epinephrine, may self-administer epinephrine, etc.):

Picture
Here: